

TM 11-6625-498-24P

TECHNICAL MANUAL

ORGANIZATIONAL, DIRECT SUPPORT, AND GENERAL SUPPORT MAINTENANCE
REPAIR PARTS AND SPECIAL TOOLS LISTS
(INCLUDING DEPOT MAINTENANCE REPAIR PARTS AND SPECIAL TOOLS)
FOR

TEST SETS, RADIO FREQUENCY POWER
AN/USM-161 AND AN/USM-161A
(NSN 6625-00-892-5541)

HEADQUARTERS, DEPARTMENT OF THE ARMY

AUGUST 1977

TECHNICAL MANUAL

NO. 11-6625-498-24P

TECHNICAL LIBRARY
ARMY MAINTENANCE
LEXINGTON, KY 40511

HEADQUARTERS
DEPARTMENT OF THE ARMY
WASHINGTON, DC, 19 AUGUST 1977

**ORGANIZATIONAL, DIRECT SUPPORT, AND GENERAL SUPPORT MAINTENANCE
REPAIR PARTS AND SPECIAL TOOLS LISTS
(INCLUDING DEPOT MAINTENANCE REPAIR PARTS AND SPECIAL TOOLS)
FOR
TEST SETS, RADIO FREQUENCY POWER
AN/USM-161 AND AN/USM-161A
(NSN 6625-00-892-5541)**

Current as of 5 May 1977

REPORTING OF ERRORS

You can improve this manual by recommending improvements using DA Forms 2028-2 (Test) located in back of the manual. Simply tear out the self-addressed form, fill it out as shown on the sample, fold it where shown, and drop it in the mail.

If there are no blank DA Forms 2028-2 (Test in the back of your manual, use the standard DA Form 2028 (Recommended Changes to Publications and Blank Forms) and forward to the Commander, US Army Electronics Command, ATTN: DRSEL-MA-Q, Fort Monmouth, NJ 07703.

In either case a reply will be furnished direct to you.

| | Page | Illus Figure |
|--|------|-----------------|
| SECTION I. Introduction | 1 | |
| II. Repair parts list..... | 5 | |
| GROUP 00 Test Sets, Radio Frequency Power AN/USM-161 and AN/USM-161A | 5 | 1-5 |
| SECTION III. Special tools list (Not applicable) | | |
| IV. National stock number and part number index | 21 | |

***This manual supersedes TM 11-6625-498-24P, 13 April 1972.**

SECTION I

INTRODUCTION

1. Scope

This manual lists spares and repair parts; special tools; special test, measurement, and diagnostic equipment (TMDE), and other special support equipment required for performance of organizational, direct support, and general support maintenance of the AN/USM-161 and AN/USM-161A. It authorizes the requisitioning and issue of spares and repair parts as indicated by the source and maintenance codes.

2. General

This Repair Parts and Special Tools List is divided into the following sections:

a. Section II. Repair Parts List. A list of spares and repair parts authorized for use in the performance of maintenance. The list also includes parts which must be removed for replacement of the authorized parts. Parts lists are composed of functional groups in numeric sequence, with the parts in each group listed in figure and item number sequence.

b. Section III. Special Tools List. Not applicable,

c. Section IV. National Stock Number and Part Number Index. A list, in National item identification number (NIIN) sequence, of all National stock numbers (NSN) appearing in the listings, followed by a list, in alphameric sequence, of all part numbers appearing in the listings. National stock numbers and part numbers are cross-referenced to each illustration figure and item number appearance.

3. Explanation of Columns

a. Illustration. This column is divided as follows:

(1) *Figure number.* Indicates the figure number of the illustration on which the item is shown.

(2) *Item number.* The number used to identify item called out in the illustration.

b. Source, Maintenance, and Recoverability (SMR) Codes.

(1) *Source code.* Source codes indicate the

manner of acquiring support items for maintenance, repair, or overhaul of end items. Source codes are entered in the first and second positions of the Uniform SMR Code format as follows:

| <i>Code</i> | <i>Definition</i> |
|-------------|--|
| PA-Item | procured and stocked for anticipated or known usage, |
| X D - A | support item that is not stocked. When required, item will be procured through normal supply channels. |

NOTE

Cannibalization or salvage may be used as a source of supply for any items source coded above except those coded XA and aircraft support items as restricted by AR 700-42.

(2) *Maintenance code.* Maintenance codes are assigned to indicate the levels of maintenance authorized to USE and REPAIR support items. The maintenance codes are entered in the third and fourth positions of the Uniform SMR Code format as follows:

(a) The maintenance code entered in the third position will indicate the lowest maintenance level authorized to remove, replace, and use the support item. The maintenance code entered in the third position will indicate one of the following levels of maintenance:

| <i>Code</i> | <i>Application/Explanation</i> |
|-------------|---|
| O-Support | item is removed, replaced, used at the organizational level. |
| H -Support | item is removed, replaced, used at the general support level. |

(b) The maintenance code entered in the fourth position indicates whether the item is to be repaired and identifies the lowest maintenance level with the capability to perform complete repair (i.e., all authorized maintenance functions). This position will contain one of the following maintenance codes:

| <i>Code</i> | <i>Application/Explanation</i> |
|-------------|---|
| H- | The lowest maintenance level capable of complete repair of the support item is the general support level. |
| Z- | Nonreparable, No repair is authorized. |

(3) *Recoverability code.* Recoverability codes are assigned to support items to indicate the disposition action on unserviceable items. The recoverability code is entered in the fifth position of the Uniform SMR Code format as follows:

Recoverability

| <i>Codes</i> | <i>Definition</i> |
|--------------|---|
| Z - | Nonreparable item. When unserviceable, condemn and dispose at the level indicated in position 3. |
| H - | Reparable item. When uneconomically repairable, condemn and dispose at the general support level. |

c. National Stock Number. Indicates the National stock number assigned to the item and will be used for requisitioning purposes.

d. Part Number. Indicates the primary number used by the manufacturer (individual, company, firm, corporation, or Government activity), which controls the design and characteristics of the item by means of its engineering drawings, specifications, standards, and inspection requirements to identify an item or range of items.

NOTE

When a stock numbered item is requisitioned, the repair part received may have a different part number than the part being replaced.

e. Federal Supply Code for Manufacturer (FSCM). The FSCM is a 5-digit numeric code listed in SB 708-42 which is used to identify the manufacturer, distributor, or Government agency, etc.

f. Description. Indicates the Federal item name and, if required, a minimum description to identify the item.

g. Unit of Measure (U/M). Indicates the standard of the basic quantity of the listed item as used in performing the actual maintenance function. This measure is expressed by a two-character alphabetical

abbreviation (e.g., ea, in, pr, etc). When the unit of measure differs from the unit of issue, the lowest unit of issue that will satisfy the required units of measure will be requisitioned.

h. Quantity Incorporated in Unit. Indicates the quantity of the item used in the breakout shown on the illustration figure, which is prepared for a functional group, subfunctional group, or an assembly.

4. Special Information

a. Usable on codes are shown in the description column. Uncoded items are applicable to all models. Identification of the usable on codes used in this publication are:

| <i>Code</i> | <i>Used on</i> |
|-------------|----------------|
| AMO | AN/USM-161 |
| AH8 | AN/USM-161A |

b. The following publications pertain to the AN/USM- 161 and AN/USM-161A and its components:

- TM 11-6625-498-12, Test Set, Radio Frequency Power AN/USM-161
- TM 11-6625-498-45, Test Set, Radio Frequency Power AN/USM-161

5. How to Locate Repair Parts

a. When National stock number or part number is unknown.

(1) *First.* Using the table of contents, determine the functional group within which the item belongs. This is necessary since illustrations are prepared for functional groups and listing are divided into the same groups.

(2) *Second.* Find the illustration covering the functional group to which the item belongs.

(3) *Third.* Identify the item on the illustration and note the illustration figure and item number of the item.

(4) *Fourth.* Using the Repair Parts Listing, find the figure and item number noted on the illustration.

b. When National stock number or part number is known.

(1) *First.* Using the Index of National Stock Numbers and Part Numbers, find the pertinent National stock number or part number. This index is in NIIN sequence followed by a list of part numbers in alphameric sequence, cross-referenced to the illustration figure number and item number.

(Next printed page is 4.)

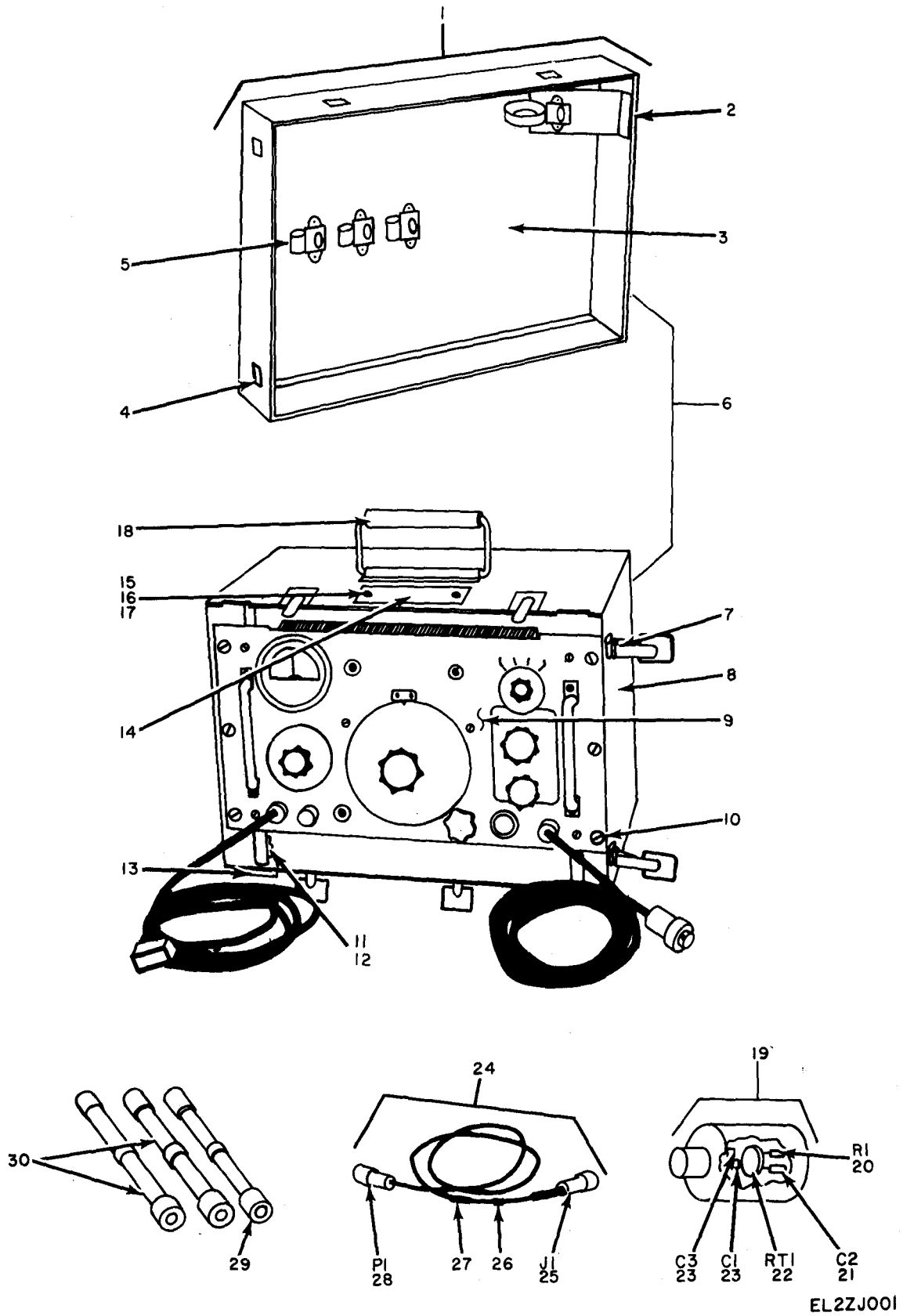

| SECTION II REPAIR PARTS LIST | | | | | TM11-6625-498-24P | | | |
|---------------------------------|-------------------|-----------------|------------------|-----------------|---|--------------------------------|-----|--------------------------|
| (1) | (2) | (3) | (4) | (5) | (6) | | (7) | (8) |
| ILLUSTRATION | | NATIONAL | PART | FSCM | DESCRIPTION | USABLE ON CODE | U/M | QTY INC IN UNIT |
| (A) FIG NO | (B) ITEM NO | STOCK NUMBER | NUMBER | | | | | |
| | | | | | GROUP 00 TEST SETS, RADIO FREQUENCY POWER AN/USM-161 AND AN/USM-161A | | | |
| 1 | 1 | XDHZZ | SMC429493 | 80063 | COVER ASSEMBLY | | EA | 1 |
| 1 | 2 | XDHZZ | 5811 | 11357 | GASKET,RUBBER | | EA | 1 |
| 1 | 3 | XDHZZ | SMC429481 | 80063 | COVER,TEST SET CASE | | EA | 1 |
| 1 | 4 | PAHZZ | 5340-00-619-0214 | SCB83314-2 | 98003 | CATCH,LUGGAGE | EA | 6 |
| 1 | 5 | XDHZZ | 4296L1 | 78584 | CLIP,SPRING TENSION | | EA | 6 |
| 1 | 6 | XDHHH | SMC429488 | 80063 | CASE ASSEMBLY | | EA | 1 |
| 1 | 7 | XDHZZ | SCB83314-1 | 98003 | STRIKE,CATCH | | EA | 6 |
| 1 | 8 | XDHZZ | SMC429479 | 80063 | CASE,TEST SET | | EA | 1 |
| 1 | 9 | XDHHH | TS-1776/USM-161 | 80063 | TEST SET,RADIO FREQUENCY,POWER | | EA | 1 |
| 1 | 10 | XDHZZ | 6184S1032 | 06540 | SCREW,CAPTIVE | | EA | 6 |
| 1 | 11 | PAHZZ | 5310-00-857-5547 | MS21044D06 | 96906 | NUT,SELF-LOCKING,HEXAGON | EA | 1 |
| 1 | 12 | PAHZZ | 5305-00-068-6534 | MS35233-31 | 96906 | SCREW,MACHINE | EA | 1 |
| 1 | 13 | XDHZZ | SMC429488-2 | 80063 | BUMPER,RUBBER | | EA | 4 |
| 1 | 14 | XDHZZ | SMB429484 | 80063 | PLATE,IDENTIFICATION | | EA | 1 |
| 1 | 15 | PAHZZ | 5310-00-938-2013 | MS35649-224 | 96906 | NUT,PLAIN,HEXAGON | EA | 4 |
| 1 | 16 | PAHZZ | 5305-00-054-5649 | MS51957-15 | 96906 | SCREW,MACHINE | EA | 4 |
| 1 | 17 | PAHZZ | 5310-00-928-2690 | MS35338-134 | 96906 | WASHER,LOCK | EA | 4 |
| 1 | 18 | XDHZZ | HA104 | 11357 | HANDLE,BALL | | EA | 1 |
| 1 | 19 | PAOZZ | 6625-00-856-9117 | DT-255/USM-161 | 80058 | BOLOMETER,RADIO FREQUENCY | AMO | EA 1 |
| 1 | 19 | XDOZZ | | DT-155A/USM-161 | 80063 | BOLOMETER,RADIO FREQUENCY | AH8 | EA 1 |
| 1 | 20 | PAHZZ | 5905-00-752-3353 | RNT0C1910F | 81349 | RESISTOR,FIXED,FILM | EA | 1 |
| 1 | 21 | PAHZZ | 5910-00-345-8105 | 1348 | 11332 | CAPACITOR,FIXED,CERAMIC | EA | 1 |
| 1 | 22 | PAHZZ | 5905-00-446-4425 | 1N277 | 81349 | THERMISTOR DISC ASSEMBLY | EA | 1 |
| 1 | 23 | PAHZZ | 5910-00-990-5177 | CM20FD821G03 | 81349 | CAPACITOR,FIXED,MICA | EA | 2 |
| 1 | 24 | PAOZZ | 5995-00-889-0815 | SMC429552 | 80063 | CABLE ASSEMBLY,RADIO FREQUENCY | EA | 1 |
| 1 | 25 | PAHZZ | 5935-00-881-6398 | UG23EU | 96906 | CONNECTOR,PLUG,ELECTRICAL | EA | 1 |
| 1 | 26 | XDHZZ | SMB429496 | 80063 | BAND,MARKER,IDENTIFICATION | | EA | 1 |
| 1 | 27 | XDHZZ | SMB429497 | 80063 | BAND,MARKER,IDENTIFICATION | | EA | 1 |
| 1 | 28 | PAHZZ | 5935-00-947-1010 | UG21EU | 96906 | CONNECTOR,PLUG,ELECTRICAL | EA | 1 |
| 1 | 29 | PAOZZ | 5905-00-856-8854 | CN844AUSM161 | 80058 | ATTENUATOR,FIXED | EA | 1 |
| 1 | 30 | PAOZZ | 6625-00-856-8855 | CN845AUSM161 | 80058 | ATTENUATOR,FIXED | EA | 2 |

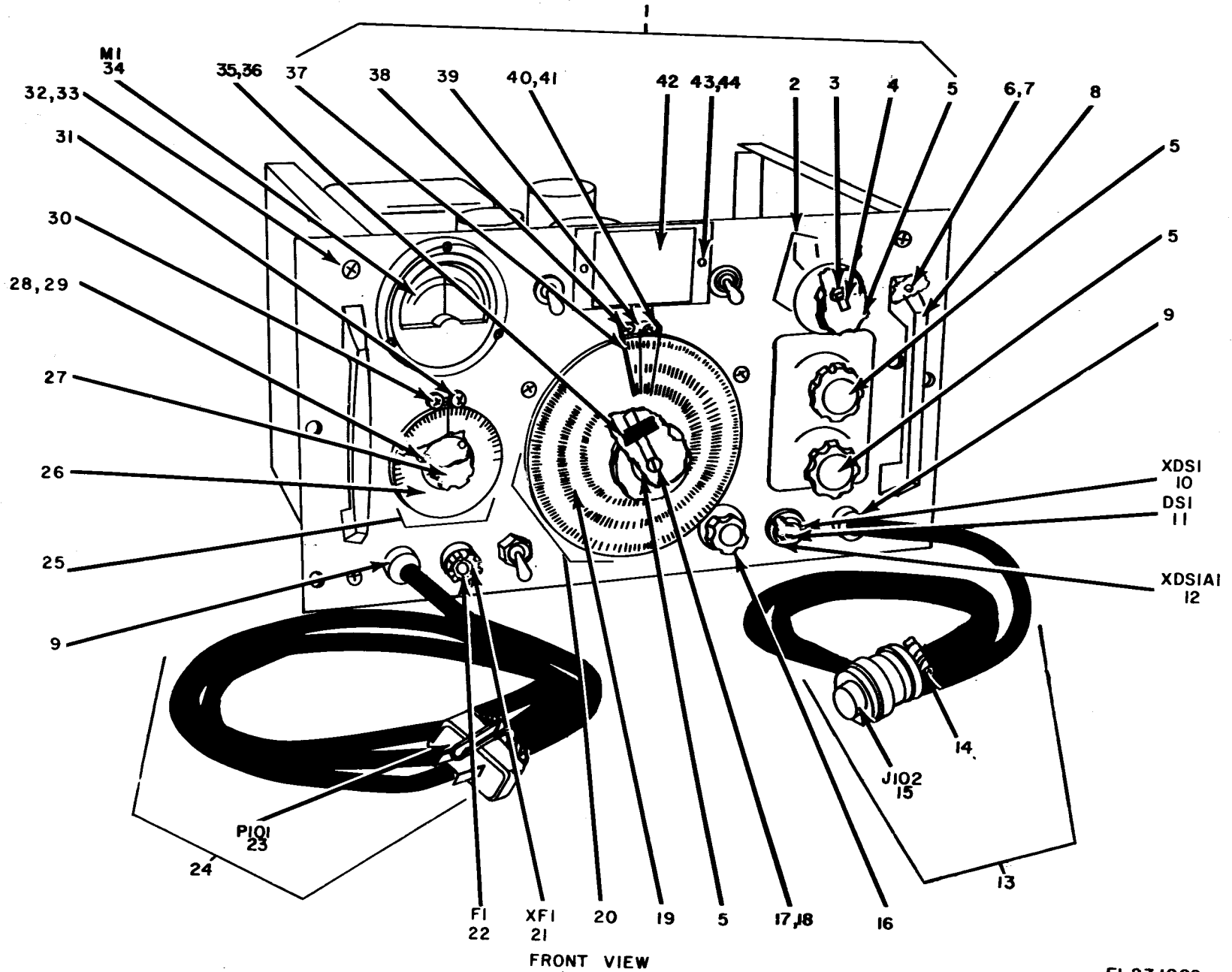
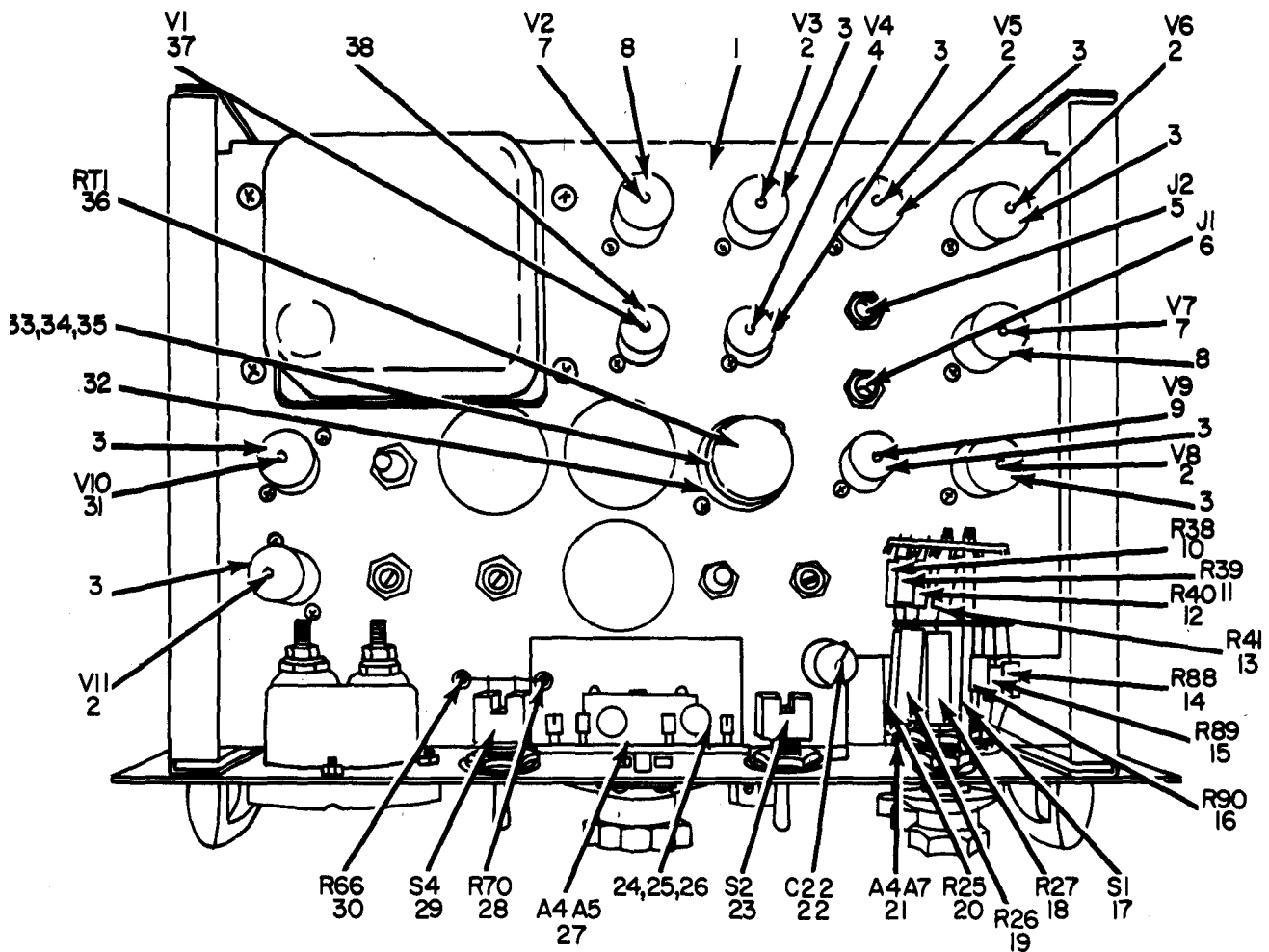

Figure 2. Test Sets, Radio Frequency Power AN/USM-161 and AN/USM-161A, Front View.

EL2ZJ002

| SECTION II | | TM11-6625-498-24P | | | | | | |
|--------------|------|-------------------|------------------|--------------|---|----------------------------|-----------------|---|
| (1) | (2) | (3) | (4) | (5) | (6) | (7) | (8) | |
| ILLUSTRATION | | | | | DESCRIPTION | USABLE ON CODE | QTY INC IN UNIT | |
| (A) | (B) | NATIONAL | PART | FSCM | | U/M | | |
| FIG | ITEM | STOCK | NUMBER | | | | | |
| NO | NO | NUMBER | | | | | | |
| 2 | 1 | XDHZZ | SMD429571 | 80063 | PANEL ASSEMBLY | EA | 1 | |
| 2 | 2 | XDHZZ | SMB429558 | 80063 | KNOB ASSEMBLY | EA | 1 | |
| 2 | 3 | XDHZZ | SMB429535 | 80063 | BUSHING,RUBBER | EA | 1 | |
| 2 | 4 | XDHZZ | SMB429536 | 80063 | COUPLING,SHAFT,RIGID | EA | 1 | |
| 2 | 5 | PAOZZ | 5355-00-543-7183 | MS91531-2N2M | 96906 | KNOB | EA | 4 |
| 2 | 6 | PAHZZ | 5305-00-984-6210 | MS35206-263 | 96906 | SCREW,MACHINE | EA | 4 |
| 2 | 7 | PAHZZ | 5310-00-045-3296 | MS35338-43 | 96906 | WASHER,LOCK | EA | 4 |
| 2 | 8 | XDHZZ | 2068 | 83330 | HANDLE,BOW | EA | 2 | |
| 2 | 9 | PAHZZ | 5975-00-273-0788 | SR6P1 | 28520 | BUSHING,STRAIN RELIEF | EA | 2 |
| 2 | 10 | XDHZZ | MS90285 | 96906 | LIGHT,INDICATOR | EA | 1 | |
| 2 | 11 | PAOZZ | 6240-00-155-8706 | MS15571-2 | 96906 | LAMP,INCANDESCENT | EA | 1 |
| 2 | 12 | PAOZZ | 6210-00-753-2834 | LC14RD | 81349 | LENS,INDICATOR LIGHT | EA | 1 |
| 2 | 13 | XDOZZ | SMB429559 | 80063 | CABLE ASSEMBLY,SPECIAL PURPOSE,ELECTRICAL | EA | 1 | |
| 2 | 14 | PAHZZ | 5935-00-259-2019 | MS3057-6B | 96906 | CLAMP,ELECTRICAL CONNECTOR | EA | 1 |
| 2 | 15 | XDHZZ | MS3106A14S5S | 96906 | CONNECTOR,PLUG,ELECTRICAL | EA | 1 | |
| 2 | 16 | XDOZZ | MS91531-2F2BM | 96906 | KNOB | EA | 1 | |
| 2 | 17 | PAHZZ | 5305-00-988-1167 | MS35206-204 | 96906 | SCREW,MACHINE | EA | 3 |
| 2 | 18 | PAHZZ | 5310-00-543-5060 | MS35338-39 | 96906 | WASHER,LOCK | EA | 3 |
| 2 | 19 | PAHZZ | 5355-00-409-5969 | SMB429540 | 80063 | DIAL,CONTROL | EA | 1 |
| 2 | 20 | XDHZZ | SMB429557 | 80063 | DIAL ASSEMBLY | EA | 1 | |
| 2 | 21 | PAHZZ | 5920-00-556-0144 | FHN20G | 81349 | FUSEHOLDER | EA | 1 |
| 2 | 22 | PAOZZ | 5920-00-280-4960 | F02A250V2A | 81349 | FUSE,CARTRIDGE | EA | 1 |
| 2 | 23 | PAHZZ | 5935-00-552-4490 | UP120M | 81349 | CONNECTOR,PLUG,ELECTRICAL | EA | 1 |
| 2 | 24 | XDOZZ | SMB429560 | 80063 | CABLE ASSEMBLY,POWER,ELECTRICAL | EA | 1 | |
| 2 | 25 | XDHZZ | SMB429556 | 80063 | DIAL ASSEMBLY | EA | 1 | |
| 2 | 26 | XDHZZ | SMC429539 | 80063 | DIAL,CONTROL | EA | 1 | |
| 2 | 27 | PAOZZ | 5355-00-614-0400 | MS91531-3N2M | 96906 | KNOB | EA | 1 |
| 2 | 28 | PAHZZ | 5305-00-889-3000 | MS35206-230 | 96906 | SCREW,MACHINE | EA | 3 |
| 2 | 29 | PAHZZ | 5310-00-045-4007 | MS35338-22 | 96906 | WASHER,LOCK | EA | 3 |
| 2 | 30 | XDHZZ | SMB429534 | 80063 | INDICATOR,DIAL | EA | 1 | |
| 2 | 31 | XDHZZ | SMB429531 | 80063 | SPACER,INDICATOR | EA | 1 | |
| 2 | 32 | PAHZZ | 5305-00-054-6670 | MS51957-45 | 96906 | SCREW,MACHINE | EA | 8 |
| 2 | 33 | PAHZZ | 5310-00-933-8119 | MS35338-137 | 96906 | WASHER,LOCK | EA | 8 |
| 2 | 34 | PAHZZ | 6625-00-345-8098 | 1727 | 11332 | AMMETER OR | EA | 1 |
| 2 | 34 | PAHZZ | 6625-00-937-5305 | SMB429528 | 80063 | AMMETER | EA | 1 |
| 2 | 35 | PAHZZ | 5365-00-554-8486 | 119 | 83330 | BEARING,SLEEVE | EA | 1 |
| 2 | 36 | PAHZZ | 5365-00-803-7307 | 5100-25 | 79136 | RING,RETAINING | EA | 1 |
| 2 | 37 | XDHZZ | SMB429533 | 80063 | INDICATOR,DIAL | EA | 1 | |
| 2 | 38 | XDHZZ | SMB429532 | 80063 | CLAMP,INDICATOR | EA | 2 | |
| 2 | 39 | XDHZZ | SMB429487 | 80063 | SPACER,INDICATOR | EA | 1 | |

| SECTION II | | TM11-6625-498-24P | | | | | | |
|--------------|------|------------------------|-------------|-------|----------------------|----------------|------|--|
| (1) | (2) | (3) | (4) | (5) | (6) | (7) | (8) | |
| ILLUSTRATION | | | | | | | QTY | |
| (A) | (B) | NATIONAL | | | DESCRIPTION | | INC | |
| FIG | ITEM | STOCK | PART | FSCM | | USABLE ON CODE | IN | |
| NO | NO | NUMBER | NUMBER | | | | UNIT | |
| | | | | | | | | |
| 2 | 40 | PAHZZ 5305-00-984-4976 | MS35206-219 | 96906 | SCREW,MACHINE | | EA 4 | |
| 2 | 41 | PAHZZ 5310-00-543-2410 | MS35338-40 | 96906 | WASHER,LOCK | | EA 4 | |
| 2 | 42 | XDHZZ | SMB429530 | 80063 | PLATE,IDENTIFICATION | | EA 1 | |
| 2 | 43 | PAHZZ 5305-00-889-3118 | MS35206-203 | 96906 | SCREW,MACHINE | | EA 4 | |
| 2 | 44 | PAHZZ 5310-00-543-5060 | MS35338-39 | 96906 | WASHER,LOCK | | EA 4 | |



EL2ZJ003

Figure 3. Test Sets, Radio Frequency Power AN/USM-161 and AN/USM-161A, Top View.

| SECTION II (1) ILLUSTRATION (A) FIG NO | | (2) (B) ITEM NO | (3) NATIONAL STOCK NUMBER | (4) PART NUMBER | (5) FSCM | TM11-6625-498-24P (6) DESCRIPTION | (7) USABLE ON CODE | U/M | (8) QTY INC IN UNIT |
|---|----|--------------------------|------------------------------------|-----------------------|-------------|---|-----------------------|-----|---------------------------------|
| 3 | 1 | XDZZ | | SMD481733 | 80063 | CHASSIS ASSEMBLY | | EA | 1 |
| 3 | 2 | PAZZ | 5960-00-062-0204 | JAN5751WA | 81349 | ELECTRON TUBE | | EA | 5 |
| 3 | 3 | PAZZ | 5960-00-264-3004 | TS103U02 | 81349 | SHIELD,ELECTRON TUBE | | EA | 8 |
| 3 | 4 | PAZZ | 5960-00-262-0286 | JAN5651WA | 81349 | ELECTRON TUBE | | EA | 1 |
| 3 | 5 | PAZZ | 5935-00-192-4789 | JJ089 | 81349 | JACK, TELEPHONE | AM0 | EA | 1 |
| 3 | 5 | PAZZ | 5935-00-192-4881 | JJ101 | 81349 | JACK, TELEPHONE | AH8 | EA | 1 |
| 3 | 6 | PAZZ | 5935-00-539-0457 | 13B | 82389 | JACK, TELEPHONE | AM0 | EA | 1 |
| 3 | 6 | PAZZ | 5935-00-192-4789 | JJ089 | 81349 | JACK, TELEPHONE | AH8 | EA | 1 |
| 3 | 7 | PAZZ | 5960-00-577-3078 | JAN5687WA | 81349 | ELECTRON TUBE | | EA | 2 |
| 3 | 8 | PAZZ | 5960-00-729-8150 | TS102U03 | 81349 | SHIELD,ELECTRON TUBE | | EA | 2 |
| 3 | 9 | PAZZ | 5960-00-669-6861 | JAN6005-6AQ5W | 81349 | ELECTRON TUBE | | EA | 1 |
| 3 | 10 | PAZZ | 5905-00-299-2008 | RC32GF753J | 81349 | RESISTOR, FIXED, COMPOSITION | | EA | 1 |
| 3 | 11 | PAZZ | 5905-00-299-2005 | RC32GF823J | 81349 | RESISTOR, FIXED, COMPOSITION | | EA | 1 |
| 3 | 12 | PAZZ | 5905-00-247-8735 | RC32GF563J | 81349 | RESISTOR, FIXED, COMPOSITION | | EA | 1 |
| 3 | 13 | PAZZ | 5905-00-171-1977 | RC42GF303J | 81349 | RESISTOR, FIXED, COMPOSITION | | EA | 1 |
| 3 | 14 | PAZZ | 5905-00-190-8879 | RC20GF183K | 81349 | RESISTOR, FIXED, COMPOSITION | | EA | 1 |
| 3 | 15 | PAZZ | 5905-00-245-0023 | RC20GF682K | 81349 | RESISTOR, FIXED, COMPOSITION | | EA | 1 |
| 3 | 16 | PAZZ | 5905-00-299-2059 | RC32GF332J | 81349 | RESISTOR, FIXED, COMPOSITION | | EA | 1 |
| 3 | 17 | PAZZ | 5930-00-086-7753 | 1738 | 11332 | SWITCH, ROTARY | AM0 | EA | 1 |
| 3 | 17 | PAZZ | 5930-00-166-9838 | SMB429486 | 80063 | SWITCH, ROTARY | AH8 | EA | 1 |
| 3 | 18 | PAZZ | 5905-00-062-6618 | 1817-2 | 11332 | RESISTOR, FIXED, WIRE WOUND | AM0 | EA | 1 |
| 3 | 18 | XDZZ | | RN65C7971C | 81349 | RESISTOR, FIXED, FILM | AH8 | EA | 1 |
| 3 | 19 | XDZZ | | RB52CE14171B | 81349 | RESISTOR, FIXED, WIRE WOUND | | EA | 1 |
| 3 | 20 | XDZZ | | RB52CE25201C | 81349 | RESISTOR, FIXED, WIRE WOUND | AM0 | EA | 1 |
| 3 | 20 | XDZZ | | RN65C2522C | 81349 | RESISTOR, FIXED, FILM | AH8 | EA | 1 |
| 3 | 21 | XDZZ | | SMC429553 | 80063 | SWITCH ASSEMBLY, POWER RANGE | | EA | 1 |
| 3 | 22 | PAZZ | 5910-00-655-0588 | CP11A3KB1C5K3 | 81349 | CAPACITOR, FIXED, PAPER DIELECTRIC | | EA | 1 |
| 3 | 23 | PAZZ | 5930-00-655-1515 | MS35058-23 | 96906 | SWITCH, TOGGLE | | EA | 1 |
| 3 | 24 | PAZZ | 5305-00-889-3000 | MS35206-230 | 96906 | SCREW, MACHINE | | EA | 2 |
| 3 | 25 | PAZZ | 5310-00-082-1404 | MS27183-6 | 96906 | WASHER, FLAT | | EA | 4 |
| 3 | 26 | PAZZ | 5310-00-045-4007 | MS35338-41 | 96906 | WASHER, LOCK | | EA | 2 |
| 3 | 27 | XDZZ | | SMB429566 | 80063 | ELECTRONIC COMPONENTS ASSEMBLY | | EA | 1 |
| 3 | 28 | XDZZ | | RB54CE66R27C | 81349 | RESISTOR, FIXED, WIRE WOUND | AM0 | EA | 1 |
| 3 | 28 | XDZZ | | RN70C66R3D | 81349 | RESISTOR, FIXED, FILM | AH8 | EA | 1 |
| 3 | 29 | PAZZ | 5930-00-655-1582 | MS35059-23 | 96906 | SWITCH, TOGGLE | | EA | 1 |
| 3 | 30 | XDZZ | | RB54CE14940C | 81349 | RESISTOR, FIXED, WIRE WOUND | | EA | 1 |
| 3 | 31 | PAZZ | 5960-00-262-0167 | JAN12AT7WA | 81349 | ELECTRON TUBE | | EA | 1 |
| 3 | 32 | XDZZ | | 19088-23D | 91506 | CLAMP, TUBE | | EA | 1 |
| 3 | 33 | PAZZ | 5310-00-062-0912 | MS35649-64 | 96906 | NUT, PLAIN, HEXAGON | | EA | 1 |
| 3 | 34 | PAZZ | 5305-00-576-0528 | MS35223-47 | 96906 | SCREW, MACHINE | | EA | 1 |

| SECTION II | | TM11-6625-498-24P | | | | | | |
|--------------|------|------------------------|------------|-------|------------------------------|----------------|------|--|
| (1) | (2) | (3) | (4) | (5) | (6) | (7) | (8) | |
| ILLUSTRATION | | | | | | | QTY | |
| (A) | (B) | NATIONAL | | | DESCRIPTION | | INC | |
| FIG | ITEM | STOCK | PART | FSCM | | USABLE ON CODE | IN | |
| NO | NO | NUMBER | NUMBER | | | | UNIT | |
| 3 | 35 | PAHZZ 5310-00-013-1074 | MS35338-72 | 96906 | WASHER, LOCK | | EA 1 | |
| 3 | 36 | PAHZZ 5905-00-299-1754 | 9-4 | 70563 | RESISTOR, CURRENT REGULATING | | EA 1 | |
| 3 | 37 | PAOZZ 5960-00-272-9182 | JAN6X4WA | 81349 | ELECTRON TUBE | | EA 1 | |
| 3 | 38 | PAOZZ 5960-00-860-7709 | M24251-6-2 | 81349 | SHIELD, ELECTRON TUBE | | EA 1 | |

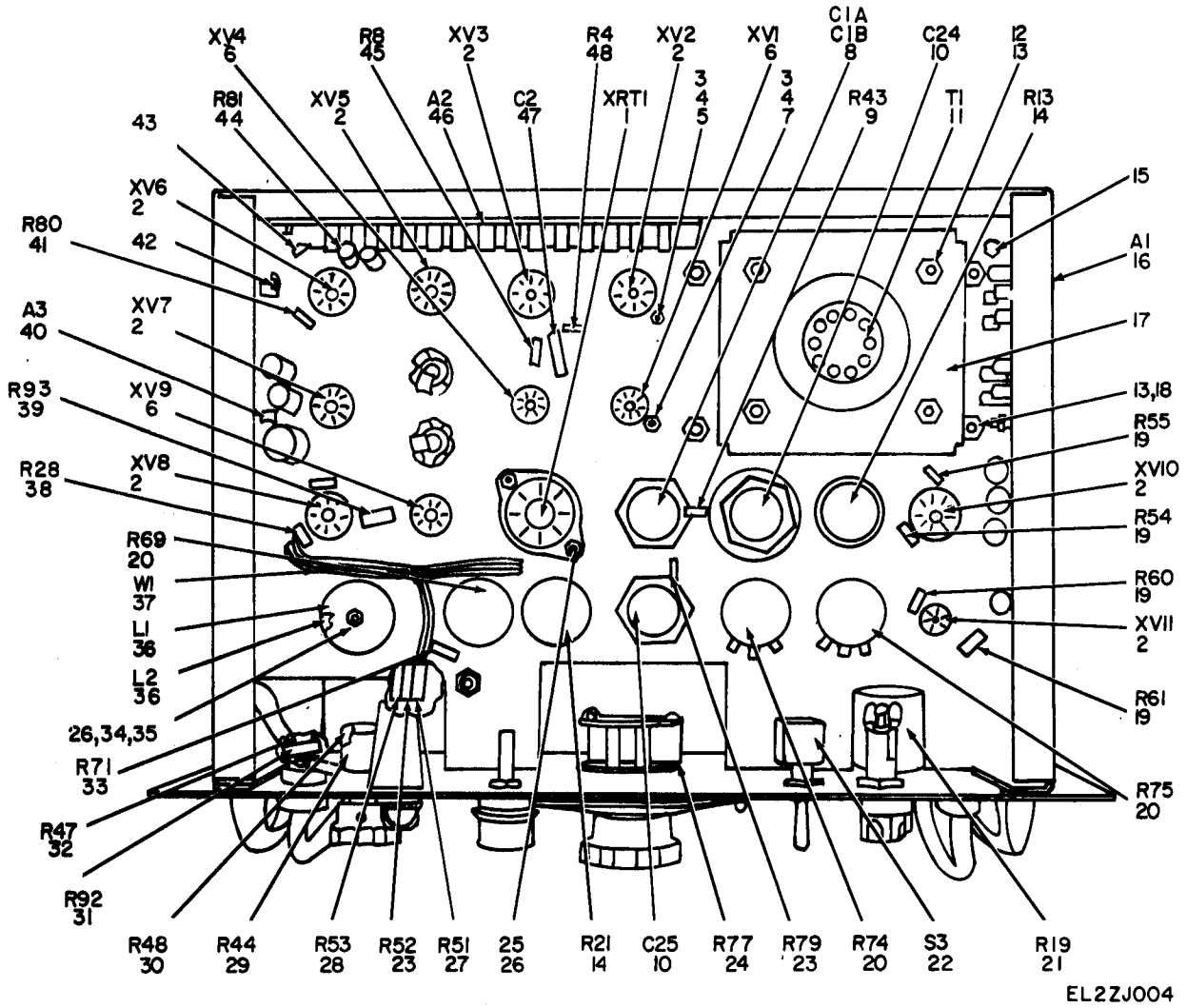

EL22J004

Figure 4. Test Sets, Radio Frequency Power AN/USM-161 and AN/USM-161A, Bottom View.

| SECTION II | | TM11-6625-498-24P | | | | | | | |
|--------------|------|-------------------|------------------|--------------|-------------|---|-----|-----|------|
| (1) | (2) | (3) | (4) | (5) | (6) | (7) | (8) | | |
| ILLUSTRATION | | | | | | | | | |
| (A) | (B) | | | | | | | | |
| FIG | ITEM | SMR | NATIONAL | PART | DESCRIPTION | USABLE ON CODE | U/M | QTY | INC |
| NO | NO | CODE | STOCK | NUMBER | FSCM | | | IN | UNIT |
| | | | NUMBER | | | | | | |
| 4 | 1 | PAHZZ | 5935-00-063-5789 | TS101P01 | 81349 | SOCKET,ELECTRON TUBE | AM0 | EA | 1 |
| 4 | 1 | PAHZZ | 5935-00-129-9358 | TS101P02 | 81349 | SOCKET,ELECTRON TUBE | AH8 | EA | 1 |
| 4 | 2 | PAHZZ | 5935-00-892-8987 | TS103P03 | 81349 | SOCKET,ELECTRON TUBE | AM0 | EA | 8 |
| 4 | 2 | PAHZZ | 5935-00-222-9828 | TS103P01 | 81349 | SOCKET,ELECTRON TUBE | AH8 | EA | 8 |
| 4 | 3 | PAHZZ | 5310-00-042-9609 | MS35338-78 | 96906 | WASHER,LOCK | | EA | 34 |
| 4 | 4 | PAHZZ | 5305-00-054-5653 | MS51957-19 | 96906 | SCREW,MACHINE | | EA | 2 |
| 4 | 5 | PAHZZ | 5935-00-259-9853 | 9SN | 71785 | STRAPNUT,ELECTRON TUBE SOCKET | | EA | 1 |
| 4 | 6 | PAHZZ | 5935-00-172-4923 | TS102P03 | 81349 | SOCKET,ELECTRON TUBE | AM0 | EA | 3 |
| 4 | 6 | PAHZZ | 5935-00-260-0516 | TS102P01 | 81349 | SOCKET,ELECTRON TUBE | AH8 | EA | 3 |
| 4 | 7 | PAHZZ | 5935-00-504-3337 | 7SN | 71785 | STRAPNUT,ELECTRON TUBE SOCKET | | EA | 1 |
| 4 | 8 | PAHZZ | 5910-00-997-8282 | CE42C400P | 81349 | CAPACITOR,FIXED,ELECTROLYTIC | | EA | 1 |
| 4 | 9 | PAHZZ | 5905-00-185-6966 | RC20GF271K | 81349 | RESISTOR,FIXED,COMPOSITION | | EA | 1 |
| 4 | 10 | PAHZZ | 5910-00-997-8284 | CE41C650F | 81349 | CAPACITOR,FIXED,ELECTROLYTIC | | EA | 2 |
| 4 | 11 | PAHZZ | 5950-00-992-4345 | SMC429529 | 80063 | TRANSFORMER,POWER,STEP-UP AND STEP-DOWN | | EA | 1 |
| 4 | 12 | PAHZZ | 5310-00-934-9763 | MS35649-265 | 96906 | NUT,PLAIN,HEXAGON | | EA | 4 |
| 4 | 13 | PAHZZ | 5310-00-054-1830 | MS35338-80 | 96906 | WASHER,LOCK | | EA | 4 |
| 4 | 14 | XDHZZ | | RA20LASB503A | 81349 | RESISTOR,VARIABLE | | EA | 2 |
| 4 | 15 | PAHZZ | 5305-00-054-5647 | MS51957-13 | 96906 | SCREW,MACHINE | | EA | 4 |
| 4 | 16 | XDHZZ | | SMB429568 | 80063 | ELECTRONIC COMPONENTS ASSEMBLY | | EA | 1 |
| 4 | 17 | XDHZZ | | SMB429546 | 80063 | BRACKET,TRANSFORMER MOUNTING | | EA | 1 |
| 4 | 18 | PAHZ | 5305-00-054-6668 | MS51957-43 | 96906 | SCREW,MACHINE | | EA | 4 |
| 4 | 19 | PAHZZ | 5905-00-106-1282 | RC20GF223K | 81349 | RESISTOR,FIXED,COMPOSITION | | EA | 4 |
| 4 | 20 | PAHZZ | 5905-00-802-7776 | RA20LASB201A | 81349 | RESISTOR,VARIABLE | | EA | 3 |
| 4 | 21 | XDHZZ | | R20016 | 97979 | RESISTOR,VARIABLE | | EA | 1 |
| 4 | 22 | PAHZZ | 5930-00-655-1514 | MS35058-22 | 96906 | SWITCH,TOGGLE | | EA | 1 |
| 4 | 23 | PAHZZ | 5905-00-110-0196 | RC20GF102K | 81349 | RESISTOR,FIXED,COMPOSITION | | EA | 2 |
| 4 | 24 | PAHZZ | 5905-00-937-5419 | SMB429537 | 80063 | RESISTOR,VARIABLE | | EA | 1 |
| 4 | 25 | PAHZZ | 5305-00-054-6651 | MS51957-27 | 96906 | SCREW,MACHINE | | EA | 2 |
| 4 | 26 | PAHZZ | 5310-00-013-1074 | MS35338-72 | 96906 | WASHER,LOCK | | EA | 3 |
| 4 | 27 | PAHZZ | 5905-00-279-1751 | RC20GF302J | 81349 | RESISTOR,FIXED,COMPOSITION | | EA | 1 |
| 4 | 28 | PAHZZ | 5905-00-111-4742 | RCR20G391JS | 81349 | RESISTOR,FIXED,COMPOSITION | | EA | 1 |
| 4 | 29 | PAHZZ | 5905-00-808-1839 | RA30LASD151A | 81349 | RESISTOR,VARIABLE | | EA | 1 |
| 4 | 30 | PAHZZ | 5905-00-539-1559 | RV4NAXSD253A | 81349 | RESISTOR,VARIABLE | | EA | 1 |
| 4 | 31 | PAHZZ | 5905-00-251-7757 | RC20GF270K | 81349 | RESISTOR,FIXED,COMPOSITION | | EA | 1 |
| 4 | 32 | PAHZZ | 5905-00-245-0023 | RC20GF682K | 81349 | RESISTOR,FIXED,COMPOSITION | | EA | 1 |
| 4 | 33 | PAHZZ | 5905-00-081-8672 | RW59G241 | 81349 | RESISTOR,FIXED,WIRE WOUND | | EA | 1 |
| 4 | 34 | PAHZZ | 5310-00-934-9748 | MS35649-244 | 96906 | NUT,PLAIN,HEXAGON | | EA | 1 |
| 4 | 35 | PAHZZ | 5305-00-054-5656 | MS51957-22 | 96906 | SCREW,MACHINE | | EA | 1 |
| 4 | 36 | PAHZZ | 5950-00-345-8103 | 1390-1 | 11332 | COIL,RADIO FREQUENCY | AM0 | EA | 2 |
| 4 | 36 | XDHZZ | | SMB429538 | 80063 | COIL,RADIO FREQUENCY | AH8 | EA | 2 |

| SECTION II | | TM11-6625-498-24P | | | | | | |
|--------------|------|-------------------|------------------|---------------|--------------------------------|------------------------------|-----------------|--|
| (1) | (2) | (3) | (4) | (5) | (6) | (7) | (8) | |
| ILLUSTRATION | | | | | DESCRIPTION | USABLE ON CODE | QTY INC IN UNIT | |
| (A) | (B) | NATIONAL | PART | FSCM | | U/M | | |
| FIG | ITEM | STOCK | NUMBER | | | | | |
| NO | NO | NUMBER | | | | | | |
| 4 | 37 | XDHZZ | SME429554 | 80063 | WIRING HARNESS | EA | 1 | |
| 4 | 38 | PAHZZ | 5905-00-192-3987 | RC20GF104K | 81349 | RESISTOR, FIXED, COMPOSITION | EA 1 | |
| 4 | 39 | PAHZZ | 5905-00-463-9584 | RRC32G602JS | 81349 | RESISTOR, FIXED, COMPOSITION | EA 1 | |
| 4 | 40 | XDHZZ | SMB429567 | 80063 | ELECTRONIC COMPONENTS ASSEMBLY | EA | 1 | |
| 4 | 41 | PAHZZ | 5905-00-279-2522 | RC20GF154J | 81349 | RESISTOR, FIXED, COMPOSITION | EA 1 | |
| 4 | 42 | PAHZZ | 5940-00-827-2653 | 505 | 79963 | TERMINAL, LUG | EA 1 | |
| 4 | 43 | PAHZZ | 5940-00-152-3890 | SMD481733-2 | 80063 | POST, BINDING | EA 1 | |
| 4 | 44 | PAHZZ | 5905-00-104-8330 | RC20GF333K | 81349 | RESISTOR, FIXED, COMPOSITION | EA 1 | |
| 4 | 45 | PAHZZ | 5905-00-114-5441 | RC20GF563K | 81349 | RESISTOR, FIXED, COMPOSITION | EA 1 | |
| 4 | 46 | XDHZZ | SMB429565 | 80063 | ELECTRONIC COMPONENTS ASSEMBLY | EA | 1 | |
| 4 | 47 | PAHZZ | 5910-00-821-4702 | CP05A1KE103K3 | 81349 | CAPACITOR, FIXED, PAPER | EA 1 | |
| 4 | 48 | PAHZZ | 5905-00-111-4732 | RC20GF125K | 81349 | RESISTOR, FIXED, COMPOSITION | EA 1 | |

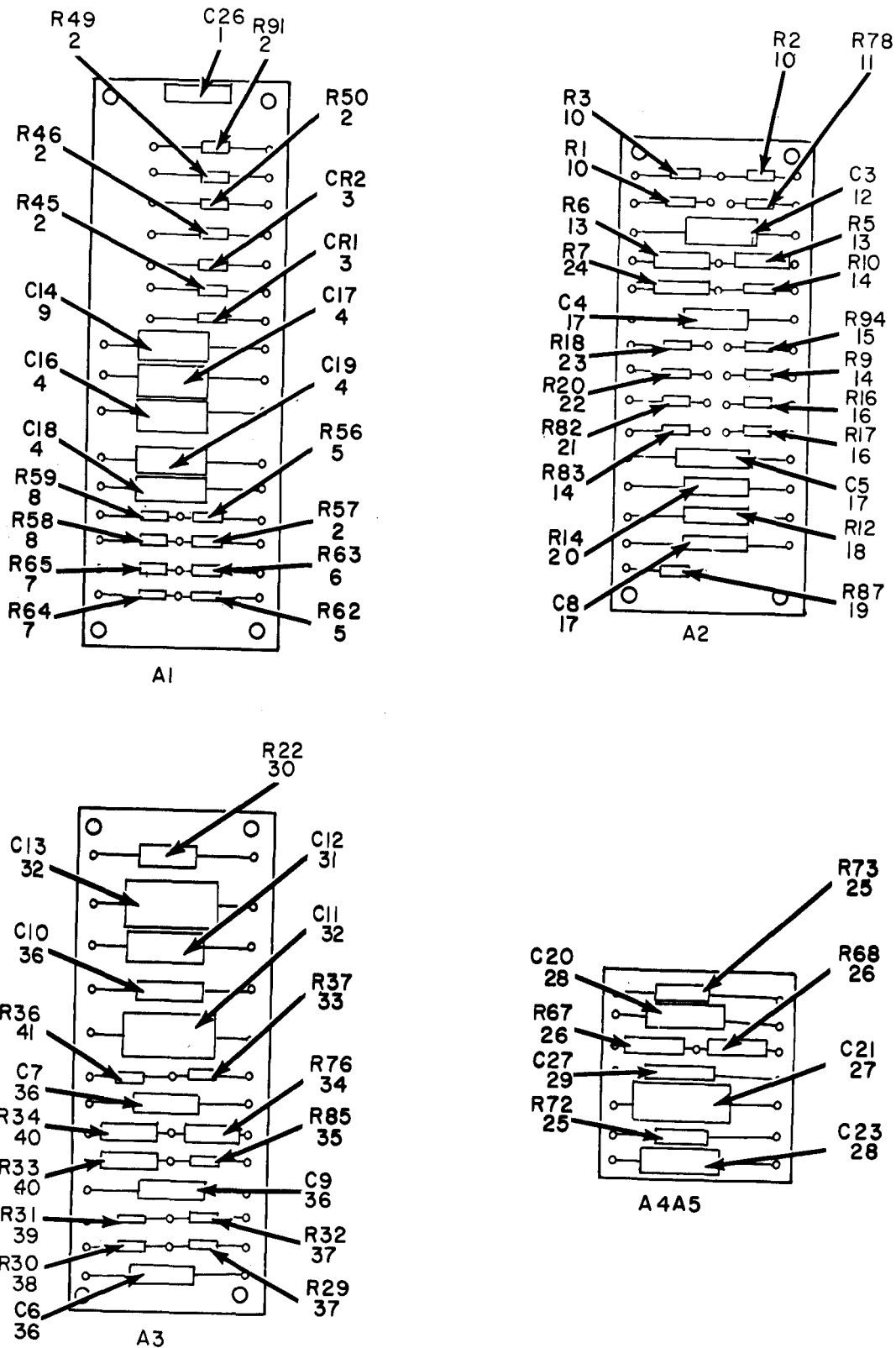

EL2ZJ005

Figure 5. Test Sets, Radio Frequency Power AN/USM-161 and AN/USM-161A, Terminal Board Assemblies.

| SECTION II (1) ILLUSTRATION | | (2) | (3) | (4) | (5) | TM11-6625-498-24P (6) | (7) | (8) |
|-----------------------------------|-------------------|-------------|-----------------------------|----------------|-------|---------------------------------|----------------|--------------------------|
| (A) FIG NO | (B) ITEM NO | SMR CODE | NATIONAL STOCK NUMBER | PART NUMBER | FSCM | DESCRIPTION | USABLE ON CODE | U/M INC IN UNIT |
| 5 | 1 | PAHZZ | 5910-00-821-4702 | CP05A1KE103K3 | 81349 | CAPACITOR, FIXED, PAPER | | EA 1 |
| 5 | 2 | PAHZZ | 5905-00-185-8510 | RC20GF103J | 81349 | RESISTOR, FIXED COMPOSITION | | EA 6 |
| 5 | 3 | PAHZZ | 5961-00-669-6884 | JAN1N277 | 81349 | SEMICONDUCTOR DEVICE, DIODE | | EA 2 |
| 5 | 4 | PAHZZ | 5910-00-825-1637 | CP05A1KC104K3 | 81349 | CAPACITOR, FIXED, PAPER | | EA 4 |
| 5 | 5 | PAHZZ | 5905-00-279-3513 | RC20GF221J | 81349 | RESISTOR, FIXED, COMPOSITION | | EA 2 |
| 5 | 6 | PAHZZ | 5905-00-190-8879 | RC20GF183K | 81349 | RESISTOR, FIXED, COMPOSITION | | EA 1 |
| 5 | 7 | PAHZZ | 5905-00-192-3987 | RC20GF104K | 81349 | RESISTOR, FIXED, COMPOSITION | | EA 2 |
| 5 | 8 | PAHZZ | 5905-00-192-0390 | RC20GF105J | 81349 | RESISTOR, FIXED, COMPOSITION | | EA 2 |
| 5 | 9 | PAHZZ | 5910-00-688-2822 | CP05A1KB104K3 | 81349 | CAPACITOR, FIXED, PAPER | | EA 1 |
| 5 | 10 | PAHZZ | 5905-00-279-2621 | RC20GF330K | 81349 | RESISTOR, FIXED, COMPOSITION | | EA 3 |
| 5 | 11 | PAHZZ | 5905-00-171-2005 | RC20GF471K | 81349 | RESISTOR, FIXED, COMPOSITION | | EA 1 |
| 5 | 12 | PAHZZ | 5910-00-825-1637 | CP05A1KC104K3 | 81349 | CAPACITOR, FIXED, PAPER | | EA 1 |
| 5 | 13 | PAHZZ | 5905-00-892-6479 | RN70D1003F | 81349 | RESISTOR, FIXED, FILM | | EA 2 |
| 5 | 14 | PAHZZ | 5905-00-114-5489 | RCR20G823JS | 81349 | RESISTOR, FIXED, COMPOSITION | | EA 3 |
| 5 | 15 | PAHZZ | 5905-00-114-5441 | RC20GF563K | 81349 | RESISTOR, FIXED, COMPOSITION OR | | EA 1 |
| 5 | 15 | PAHZZ | 5905-00-279-2514 | RC20GF564J | 81349 | RESISTOR, FIXED, COMPOSITION | | EA 1 |
| 5 | 16 | PAHZZ | 5905-00-279-2519 | RC20GF334J | 81349 | RESISTOR, FIXED, COMPOSITION | | EA 2 |
| 5 | 17 | PAHZZ | 5910-00-821-4702 | CP05A1KE103K3 | 81349 | CAPACITOR, FIXED, PAPER | | EA 3 |
| 5 | 18 | PAHZZ | 5905-00-825-3614 | RB54CE13002F | 81349 | RESISTOR, FIXED, WIRE WOUND | AM0 | EA 1 |
| 5 | 18 | PAHZZ | 5905-00-866-0796 | RN70D1303F | 81349 | RESISTOR, FIXED, FILM | AH8 | EA 1 |
| 5 | 19 | PAHZZ | 5905-00-221-5848 | RC20GF824J | 81349 | RESISTOR, FIXED, COMPOSITION | | EA 1 |
| 5 | 20 | PAHZZ | 5905-00-883-9196 | RB54CE20002F | 81349 | RESISTOR, FIXED, WIRE WOUND | AM0 | EA 1 |
| 5 | 20 | PAHZZ | 5905-00-993-5953 | RN70D2003F | 81349 | RESISTOR, FIXED, FILM | AH8 | EA 1 |
| 5 | 21 | PAHZZ | 5905-00-279-2522 | RC20GF154J | 81349 | RESISTOR, FIXED COMPOSITION | | EA 1 |
| 5 | 22 | PAHZZ | 5905-00-279-2514 | RC20GF564J | 81349 | RESISTOR, FIXED, COMPOSITION | | EA 2 |
| 5 | 23 | PAHZZ | 5905-00-249-3661 | RC20GF683J | 81349 | RESISTOR, FIXED, COMPOSITION | | EA 1 |
| 5 | 24 | PAHZZ | 5905-00-071-2846 | RN70D1213F | 81349 | RESISTOR, FIXED, FILM | | EA 1 |
| 5 | 25 | PAHZZ | 5905-00-062-6605 | 1739-2 | 11332 | RESISTOR, FIXED, FILM | AM0 | EA 2 |
| 5 | 25 | XDHZZ | | RN70C4000D | 81349 | RESISTOR, FIXED, FILM | AH8 | EA 2 |
| 5 | 26 | PAHZZ | 5905-00-062-8159 | 1739-1 | 11332 | RESISTOR, FIXED, FILM | AM0 | EA 2 |
| 5 | 26 | PAHZZ | 5905-00-851-7344 | RN70C2000D | 81349 | RESISTOR, FIXED, FILM | AM8 | EA 2 |
| 5 | 27 | PAHZZ | 5910-00-823-1148 | CP05A1KB474K3 | 81349 | CAPACITOR, FIXED, PAPER | | EA 1 |
| 5 | 28 | PAHZZ | 5910-00-825-1637 | CP05A1KC104K3 | 81349 | CAPACITOR, FIXED, PAPER | | EA 2 |
| 5 | 29 | PAHZZ | 5910-00-821-4702 | CP05A1KE103K3 | 81349 | CAPACITOR, FIXED, PAPER | | EA 1 |
| 5 | 30 | PAHZZ | 5905-00-889-0058 | RB54CE98050C | 81349 | RESISTOR, FIXED, WIRE WOUND | AM0 | EA 1 |
| 5 | 30 | PAHZZ | 5905-00-997-5235 | RN70C9801C | 81349 | RESISTOR, FIXED, FILM | AH8 | EA 1 |
| 5 | 31 | PAHZZ | 5910-00-688-2822 | CP05A1KB104K3 | 81349 | CAPACITOR, FIXED, PAPER | | EA 1 |
| 5 | 32 | PAHZZ | 5910-00-823-1148 | CP05A1KB474K3 | 81349 | CAPACITOR, FIXED, PAPER | | EA 2 |
| 5 | 33 | PAHZZ | 5905-00-141-0592 | RC20GF122K | 81349 | RESISTOR, FIXED, COMPOSITION | | EA 1 |
| 5 | 34 | PAHZZ | 5905-00-878-7846 | RW59G911 | 81349 | RESISTOR, FIXED, WIREWOUND | | EA 1 |

| SECTION II | | TM11-6625-498-24P | | | | | | |
|--------------|------|------------------------|---------------|-------|------------------------------|----------------|------|--|
| (1) | (2) | (3) | (4) | (5) | (6) | (7) | (8) | |
| ILLUSTRATION | | | | | | | QTY | |
| (A) | (B) | NATIONAL | PART | | DESCRIPTION | USABLE ON CODE | INC | |
| FIG | ITEM | STOCK | NUMBER | FSCM | | | IN | |
| NO | NO | NUMBER | NUMBER | | | | UNIT | |
| 5 | 35 | PAHZZ 5905-00-252-4018 | RC20GF470J | 81349 | RESISTOR, FIXED COMPOSITION | | EA 1 | |
| 5 | 36 | PAHZZ 5910-00-825-1637 | CP05A1KE103K3 | 81349 | CAPACITOR, FIXED, PAPER | | EA 4 | |
| 5 | 37 | PAHZZ 5905-00-192-0390 | RC20GF105J | 81349 | RESISTOR, FIXED, COMPOSITION | | EA 2 | |
| 5 | 38 | PAHZZ 5905-00-110-0196 | RC20GF102K | 81349 | RESISTOR, FIXED, COMPOSITION | | EA 1 | |
| 5 | 39 | PAHZZ 5905-00-190-8884 | RC20GF123K | 81349 | RESISTOR, FIXED, COMPOSITION | | EA 1 | |
| 5 | 40 | PAHZZ 5905-00-713-2533 | RN70D1430F | 81349 | RESISTOR, FIXED, FILM | | EA 2 | |
| 5 | 41 | PAHZZ 5905-00-185-6946 | RC20GF474K | 81349 | RESISTOR, FIXED, COMPOSITION | | EA 1 | |

| NOTE: LATEST NATIONAL STOCK NUMBER AND PART NUMBER ASSIGNMENTS ARE INCLUDED AT END OF INDEX | | | | | |
|---|------------------------------|------------------------|------------------|---------------------------|---------------------|
| STOCK NUMBER | STOCK NUMBER FIGURE NO | AND PART ITEM NO | STOCK NUMBER | INC LUDED FIGURE NO | INDEX ITEM NO |
| 5310-00-042-9609 | 4 | 3 | 5905-00-299-2059 | 3 | 16 |
| 5310-00-045-4007 | 2 | 29 | 6625-00-345-8098 | 2 | 34 |
| 5310-00-054-1830 | 4 | 13 | 5950-00-345-8103 | 4 | 36 |
| 5305-00-054-6670 | 2 | 32 | 5910-00-345-8105 | 1 | 21 |
| 5960-00-062-0204 | 3 | 2 | 5355-00-409-5969 | 2 | 19 |
| 5310-00-062-0912 | 3 | 33 | 5905-00-446-4425 | 1 | 22 |
| 5905-00-062-6605 | 5 | 25 | 5935-00-504-3337 | 4 | 7 |
| 5905-00-062-6618 | 3 | 18 | 5935-00-539-0457 | 3 | 6 |
| 5905-00-062-8159 | 5 | 26 | 5905-00-539-1559 | 4 | 30 |
| 5935-00-063-5789 | 4 | 1 | 5355-00-543-7183 | 2 | 5 |
| 5905-00-071-2846 | 5 | 24 | 5935-00-552-4490 | 2 | 23 |
| 5905-00-081-8672 | 4 | 33 | 5365-00-554-8486 | 2 | 35 |
| 5310-00-082-1404 | 3 | 25 | 5920-00-556-0144 | 2 | 21 |
| 5930-00-086-7753 | 3 | 17 | 5305-00-576-0528 | 3 | 34 |
| 5905-00-104-8330 | 4 | 44 | 5960-00-577-3078 | 3 | 7 |
| 5905-00-106-1282 | 4 | 19 | 5355-00-614-0400 | 2 | 27 |
| 5905-00-110-0196 | 4 | 23 | 5910-00-655-0588 | 3 | 22 |
| 5905-00-110-0196 | 5 | 38 | 5930-00-655-1514 | 4 | 22 |
| 5905-00-111-4732 | 4 | 48 | 5930-00-655-1515 | 3 | 23 |
| 5905-00-114-5441 | 4 | 45 | 5930-00-655-1582 | 3 | 29 |
| 5935-00-129-9358 | 4 | 1 | 5960-00-669-6861 | 3 | 9 |
| 5905-00-141-0592 | 5 | 33 | 5961-00-669-6884 | 5 | 3 |
| 5935-00-149-3483 | 1 | 1 | 5910-00-688-2822 | 5 | 9 |
| 5940-00-152-3890 | 4 | 43 | 5910-00-688-2822 | 5 | 31 |
| 6240-00-155-8706 | 2 | 11 | 5905-00-713-2533 | 5 | 40 |
| 5930-00-166-9838 | 3 | 17 | | | |
| 5905-00-171-1977 | 3 | 13 | 5960-00-729-8150 | 3 | 8 |
| 5905-00-171-2005 | 5 | 11 | 5905-00-752-3353 | 1 | 20 |
| 5935-00-172-4923 | 4 | 6 | 6210-00-753-2834 | 2 | 12 |
| 5905-00-185-6946 | 5 | 41 | 5905-00-802-7776 | 4 | 20 |
| 5905-00-185-6966 | 4 | 9 | 5365-00-803-7307 | 2 | 36 |
| 5905-00-185-8510 | 5 | 2 | 5905-00-808-1839 | 4 | 29 |
| | | | 5910-00-821-4702 | 5 | 1 |
| 5905-00-190-8879 | 3 | 14 | 5910-00-821-4702 | 5 | 17 |
| 5905-00-190-8879 | 5 | 6 | 5910-00-821-4702 | 5 | 29 |
| 5905-00-190-8884 | 5 | 39 | 5910-00-823-1148 | 5 | 27 |
| 5905-00-192-0390 | 5 | 8 | 5910-00-823-1148 | 5 | 32 |
| 5905-00-192-0390 | 5 | 37 | 5910-00-825-1637 | 5 | 4 |
| 5905-00-192-3987 | 4 | 38 | 5910-00-825-1637 | 5 | 12 |
| 5905-00-192-3987 | 5 | 7 | 5910-00-825-1637 | 5 | 28 |
| 5935-00-192-4789 | 3 | 5 | 5910-00-825-1637 | 5 | 36 |
| 5935-00-192-4789 | 3 | 6 | 5905-00-825-3614 | 5 | 18 |
| 5935-00-192-4881 | 3 | 5 | 5940-00-827-2653 | 4 | 42 |
| 5905-00-221-5848 | 5 | 19 | 5905-00-851-7344 | 5 | 26 |
| 5935-00-222-9828 | 4 | 2 | 5905-00-856-8854 | 1 | 29 |
| 5905-00-245-0023 | 3 | 15 | 6625-00-856-8855 | 1 | 30 |
| 5905-00-245-0023 | 4 | 32 | 6625-00-856-9117 | 1 | 19 |
| 5905-00-247-8735 | 3 | 12 | | | |
| 5905-00-249-3661 | 5 | 23 | 5310-00-857-5547 | 1 | 11 |
| 5905-00-251-7757 | 4 | 31 | 5960-00-860-7709 | 3 | 38 |
| 5905-00-252-4018 | 5 | 35 | 5905-00-866-0796 | 5 | 18 |
| 5935-00-259-2019 | 2 | 14 | 5905-00-878-7846 | 5 | 34 |
| 5935-00-259-9853 | 4 | 5 | 5935-00-881-6398 | 1 | 25 |
| 5935-00-260-0516 | 4 | 6 | 5905-00-883-9196 | 5 | 20 |
| 5960-00-262-0167 | 3 | 31 | 5905-00-889-0058 | 5 | 30 |
| 5960-00-262-0286 | 3 | 4 | 5995-00-889-0815 | 1 | 24 |
| 5960-00-264-3004 | 3 | 3 | 5305-00-889-3000 | 2 | 28 |
| 5960-00-272-9182 | 3 | 37 | 5305-00-889-3000 | 3 | 24 |
| 5975-00-273-0788 | 2 | 9 | 5905-00-892-6479 | 5 | 13 |
| 5905-00-279-1751 | 4 | 27 | 5935-00-892-8987 | 4 | 2 |
| 5905-00-279-2514 | 5 | 15 | 5310-00-934-9748 | 4 | 34 |
| 5905-00-279-2514 | 5 | 22 | 6625-00-937-5305 | 2 | 34 |
| 5905-00-279-2519 | 5 | 16 | 5905-00-937-5419 | 4 | 24 |
| 5905-00-279-2522 | 4 | 41 | 5935-00-947-1010 | 1 | 28 |
| 5905-00-279-2522 | 5 | 21 | 5305-00-984-6210 | 2 | 6 |
| 5905-00-279-2621 | 5 | 10 | 5305-00-988-1167 | 2 | 17 |
| 5905-00-279-3513 | 5 | 5 | 5950-00-992-4345 | 4 | 11 |
| 5920-00-280-4960 | 2 | 22 | 5905-00-993-5953 | 5 | 20 |
| 5905-00-299-1754 | 3 | 36 | 5905-00-997-5235 | 5 | 30 |
| 5905-00-299-2005 | 3 | 11 | 5910-00-997-8282 | 4 | 8 |
| 5905-00-299-2008 | 3 | 10 | 5910-00-997-8284 | 4 | 10 |

| PART NUMBER | FSCM | FIG NO | ITEM NO | PART NUMBER | FSCM | FIG NO | ITEM NO |
|----------------|-------|-----------|------------|----------------|-------|-----------|------------|
| CE41C650F | 81349 | 4 | 10 | CP05A1KB104K3 | 81349 | 5 | 31 |
| CE42C400P | 81349 | 4 | 8 | CP05A1KB474K3 | 81349 | 5 | 27 |
| CM20FD821G03 | 81349 | 1 | 23 | CP05A1KB474K3 | 81349 | 5 | 32 |
| CP05A1KB104K3 | 81349 | 5 | 9 | CP05A1KC104K3 | 81349 | 5 | 4 |

TM11-6625-498-24P
SECTION IV
NATIONAL STOCK NUMBER AND PART NUMBER INDEX

| PART NUMBER | FSCM | FIG NO | ITEM NO | PART NUMBER | FSCM | FIG NO | ITEM NO |
|----------------|-------|--------|---------|--------------|-------|--------|---------|
| CP05A1KC104K3 | 81349 | 5 | 12 | RC20GF102K | 81349 | 5 | 38 |
| CP05A1KC104K3 | 81349 | 5 | 28 | RC20GF103J | 81349 | 5 | 2 |
| CP05A1KE103K3 | 81349 | 4 | 47 | RC20GF104K | 81349 | 4 | 38 |
| CP05A1KE103K3 | 81349 | 5 | 1 | RC20GF104K | 81349 | 5 | 7 |
| CP05A1KE103K3 | 81349 | 5 | 17 | RC20GF105J | 81349 | 5 | 8 |
| CP05A1KE103K3 | 81349 | 5 | 29 | RC20GF105J | 81349 | 5 | 37 |
| CP05A1KE103K3 | 81349 | 5 | 36 | RC20GF122K | 81349 | 5 | 33 |
| CP11A3KBC5K3 | 81349 | 3 | 22 | RC20GF123K | 81349 | 5 | 39 |
| DT-255/USM-161 | 80058 | 1 | 19 | RC20GF125K | 81349 | 4 | 48 |
| FHN20G | 81349 | 2 | 21 | RC20GF154J | 81349 | 4 | 41 |
| F02A250V2A | 81349 | 2 | 22 | RC20GF154J | 81349 | 5 | 21 |
| HA104 | 11357 | 1 | 18 | RC20GF183K | 81349 | 3 | 14 |
| JAN1N277 | 81349 | 5 | 3 | RC20GF183K | 81349 | 5 | 6 |
| JAN12AT7WA | 81349 | 3 | 31 | RC20GF221J | 81349 | 5 | 5 |
| JAN5651WA | 81349 | 3 | 4 | RC20GF223K | 81349 | 4 | 19 |
| JAN5687WA | 81349 | 3 | 7 | RC20GF270K | 81349 | 4 | 31 |
| JAN5751WA | 81349 | 3 | 2 | RC20GF271K | 81349 | 4 | 9 |
| JAN6X4WA | 81349 | 3 | 37 | RC20GF302J | 81349 | 4 | 27 |
| JAN6005-6AQ5W | 81349 | 3 | 9 | RC20GF330K | 81349 | 5 | 10 |
| JJ089 | 81349 | 3 | 5 | RC20GF333K | 81349 | 4 | 44 |
| JJ089 | 81349 | 3 | 6 | RC20GF334J | 81349 | 5 | 16 |
| JJ101 | 81349 | 3 | 5 | | | | |
| LC14RD | 81349 | 2 | 12 | RC20GF470J | 81349 | 5 | 35 |
| | | | | RC20GF471K | 81349 | 5 | 11 |
| MS15571-2 | 96906 | 2 | 11 | RC20GF474K | 81349 | 5 | 41 |
| MS21044D06 | 96906 | 1 | 11 | RC20GF563K | 81349 | 4 | 45 |
| MS27183-6 | 96906 | 3 | 25 | RC20GF563K | 81349 | 5 | 15 |
| MS3057-6B | 96906 | 2 | 14 | RC20GF564J | 81349 | 5 | 15 |
| MS3106A14S5S | 96906 | 2 | 15 | RC20GF564J | 81349 | 5 | 22 |
| | | | | RC20GF682K | 81349 | 3 | 15 |
| MS35058-22 | 96906 | 4 | 22 | RC20GF682K | 81349 | 4 | 32 |
| MS35058-23 | 96906 | 3 | 23 | RC20GF683J | 81349 | 5 | 23 |
| MS35059-23 | 96906 | 3 | 29 | | | | |
| MS35206-204 | 96906 | 2 | 17 | RC20GF824J | 81349 | 5 | 19 |
| MS35206-219 | 96906 | 2 | 40 | RC32GF332J | 81349 | 3 | 16 |
| MS35206-230 | 96906 | 2 | 28 | RC32GF563J | 81349 | 3 | 12 |
| MS35206-230 | 96906 | 3 | 24 | | | | |
| MS35206-263 | 96906 | 2 | 6 | RC32GF753J | 81349 | 3 | 10 |
| | | | | RC32GF823J | 81349 | 3 | 11 |
| | | | | RC42GF303J | 81349 | 3 | 13 |
| MS35223-47 | 96906 | 3 | 34 | | | | |
| | | | | RNT0C1910F | 81349 | 1 | 20 |
| | | | | RN65C2522C | 81349 | 3 | 20 |
| | | | | RN65C7971C | 81349 | 3 | 18 |
| MS35233-31 | 96906 | 1 | 12 | RN70C2000D | 81349 | 5 | 26 |
| | | | | RN70C4000D | 81349 | 5 | 25 |
| | | | | RN70C66R3D | 81349 | 3 | 28 |
| | | | | RN70C9801C | 81349 | 5 | 30 |
| | | | | RN70D1003F | 81349 | 5 | 13 |
| | | | | RN70D1213F | 81349 | 5 | 24 |
| MS35338-22 | 96906 | 2 | 29 | RN70D1303F | 81349 | 5 | 18 |
| MS35338-39 | 96906 | 2 | 18 | RN70D1430F | 81349 | 5 | 40 |
| MS35338-72 | 96906 | 3 | 35 | RN70D2003F | 81349 | 5 | 20 |
| MS35338-72 | 96906 | 4 | 26 | RV4NAXSD253A | 81349 | 4 | 30 |
| | | | | RW59G241 | 81349 | 4 | 33 |
| MS35338-78 | 96906 | 4 | 3 | RW59G911 | 81349 | 5 | 34 |
| MS35338-80 | 96906 | 4 | 13 | R20016 | 97979 | 4 | 21 |
| | | | | SCB83314-1 | 98003 | 1 | 7 |
| MS35649-224 | 96906 | 1 | 15 | SCB83314-2 | 98003 | 1 | 4 |
| MS35649-244 | 96906 | 4 | 34 | SMB429484 | 80063 | 1 | 14 |
| MS35649-64 | 96906 | 3 | 33 | SMB429486 | 80063 | 3 | 17 |
| | | | | SMB429487 | 80063 | 2 | 39 |
| MS51957-45 | 96906 | 2 | 32 | SMB429496 | 80063 | 1 | 26 |
| MS90285 | 96906 | 2 | 10 | SMB429497 | 80063 | 1 | 27 |
| | | | | SMB429528 | 80063 | 2 | 34 |
| MS91531-2F2BM | 96906 | 2 | 16 | SMB429530 | 80063 | 2 | 42 |
| MS91531-2N2M | 96906 | 2 | 5 | SMB429531 | 80063 | 2 | 31 |
| MS91531-3N2M | 96906 | 2 | 27 | SMB429532 | 80063 | 2 | 38 |
| RA20LASB201A | 81349 | 4 | 20 | SMB429533 | 80063 | 2 | 37 |
| RA20LASB503A | 81349 | 4 | 14 | SMB429534 | 80063 | 2 | 30 |
| RA30LASD151A | 81349 | 4 | 29 | SMB429535 | 80063 | 2 | 3 |
| RB52CE14171B | 81349 | 3 | 19 | SMB429536 | 80063 | 2 | 4 |
| RB52CE25201C | 81349 | 3 | 20 | SMB429537 | 80063 | 4 | 24 |
| RB54CE13002F | 81349 | 5 | 18 | SMB429538 | 80063 | 4 | 36 |
| RB54CE14940C | 81349 | 3 | 30 | SMB429540 | 80063 | 2 | 19 |
| RB54CE20002F | 81349 | 5 | 20 | SMB429546 | 80063 | 4 | 17 |
| RB54CE66R27C | 81349 | 3 | 28 | | | | |
| RB54CE98050C | 81349 | 5 | 30 | | | | |
| RC20GF102K | 81349 | 4 | 23 | SMB429556 | 80063 | 2 | 25 |

SECTION IV

NATIONAL STOCK NUMBER AND PART NUMBER INDEX

TM11-6625-498-24P

| PART NUMBER | FSCM | FIG NO | ITEM NO | PART NUMBER | FSCM | FIG NO | ITEM NO |
|-------------|-------|--------|---------|-------------|-------|--------|---------|
| SMB429557 | 80063 | 2 | 20 | TS102U03 | 81349 | 3 | 8 |
| SMB429558 | 80063 | 2 | 2 | | | | |
| SMB429559 | 80063 | 2 | 13 | TS103P01 | 81349 | 4 | 2 |
| SMB429560 | 80063 | 2 | 24 | TS103P03 | 81349 | 4 | 2 |
| SMB429565 | 80063 | 4 | 46 | TS103U02 | 81349 | 3 | 3 |
| SMB429566 | 80063 | 3 | 27 | UP120M | 81349 | 2 | 23 |
| SMB429567 | 80063 | 4 | 40 | 1N277 | 81349 | 1 | 22 |
| SMB429568 | 80063 | 4 | 16 | 119 | 83330 | 2 | 35 |
| SMC429479 | 80063 | 1 | 8 | 13B | 82389 | 3 | 6 |
| SMC429481 | 80063 | 1 | 3 | 1348 | 11332 | 1 | 21 |
| SMC429488 | 80063 | 1 | 6 | 1390-1 | 11332 | 4 | 36 |
| SMC429488-2 | 80063 | 1 | 13 | 1727 | 11332 | 2 | 34 |
| SMC429493 | 80063 | 1 | 2 | 1738 | 11332 | 3 | 17 |
| SMC429529 | 80063 | 4 | 11 | 1739-1 | 11332 | 5 | 26 |
| SMC429539 | 80063 | 2 | 26 | 1739-2 | 11332 | 5 | 25 |
| SMC429552 | 80063 | 1 | 24 | 1817-2 | 11332 | 3 | 18 |
| SMC429553 | 80063 | 3 | 21 | 19088-23D | 91506 | 3 | 32 |
| SMD429571 | 80063 | 2 | 1 | 2068 | 83330 | 2 | 8 |
| | | | | 4296L1 | 78584 | 1 | 5 |
| SMD481733-2 | 80063 | 4 | 43 | 505 | 79963 | 4 | 42 |
| SME429554 | 80063 | 4 | 37 | 5100-25 | 79136 | 2 | 36 |
| SR6P1 | 28520 | 2 | 9 | 5811 | 11357 | 1 | 2 |
| TS101P01 | 81349 | 4 | 1 | 6184SS1032 | 06540 | 1 | 10 |
| TS101P02 | 81349 | 4 | 1 | 7SN | 71785 | 4 | 7 |
| TS102P01 | 81349 | 4 | 6 | 9-4 | 70563 | 3 | 36 |
| TS102P03 | 81349 | 4 | 6 | 9SN | 71785 | 4 | 5 |

LATEST NATIONAL STOCK NUMBER ASSIGNMENTS

| STOCK NUMBER | FIG NO | ITEM NO | STOCK NUMBER | FIG NO | ITEM NO |
|------------------|--------|---------|------------------|--------|---------|
| 5310-00-013-1074 | 3 | 35 | 5310-00-543-5060 | 2 | 18 |
| 5310-00-013-1074 | 4 | 26 | 5310-00-543-5060 | 2 | 44 |
| 5305-00-054-5653 | 4 | 4 | 5340-00-619-0214 | 1 | 4 |
| 5305-00-068-6534 | 1 | 12 | 5910-00-821-4702 | 4 | 47 |
| 5905-00-111-4742 | 4 | 28 | 5310-00-938-2013 | 1 | 15 |
| 5905-00-114-5441 | 5 | 15 | 5305-00-984-4976 | 2 | 40 |
| 5905-00-114-5489 | 5 | 14 | 5910-00-990-5177 | 1 | 23 |
| 5310-00-543-2410 | 2 | 41 | | | |

LATEST PART NUMBER ASSIGNMENTS

| PART NUMBER | FSCM | FIG NO | ITEM NO |
|-----------------|-------|--------|---------|
| CN844AUSM161 | 80058 | 1 | 29 |
| CN845AUSM161 | 80058 | 1 | 30 |
| DT-155A/USM-161 | 80063 | 1 | 19 |
| MS35338-39 | 96906 | 2 | 44 |
| MS35338-40 | 96906 | 2 | 41 |
| MSS1957-19 | 96906 | 4 | 4 |
| MS24251-6-2 | 81349 | 3 | 38 |
| RCR20G391JS | 81349 | 4 | 28 |
| RCR20G823JS | 81349 | 5 | 14 |
| SMD481733 | 80063 | 3 | 1 |
| TS-1776/USM-161 | 80063 | 1 | 9 |
| UG21EU | 96906 | 1 | 28 |
| UG23EU | 96906 | 1 | 25 |

ADDITIONAL LATEST NATIONAL STOCK NUMBER ASSIGNMENTS

| STOCK NUMBER | FIG NO | ITEM NO | PART NUMBER | FSCM | FIG NO | ITEM NO |
|------------------|--------|---------|-------------|-------|--------|---------|
| 5310-00-045-3296 | 2 | 7 | MS35206-203 | 96906 | 2 | 43 |
| 5310-00-045-4007 | 3 | 26 | MS35338-134 | 96906 | 1 | 17 |
| 5305-00-054-5647 | 4 | 15 | MS35338-137 | 96906 | 2 | 33 |
| 5305-00-054-5649 | 1 | 16 | MS35338-41 | 96906 | 3 | 26 |
| 5305-00-054-5656 | 4 | 35 | MS35338-43 | 96906 | 2 | 7 |
| 5305-00-054-6651 | 4 | 25 | MS35649-265 | 96906 | 4 | 12 |
| 5305-00-054-6668 | 4 | 18 | MS51957-13 | 96906 | 4 | 15 |
| 5905-00-463-9584 | 4 | 39 | MS51957-15 | 96906 | 1 | 16 |
| 5305-00-889-3118 | 2 | 43 | MS51957-22 | 96906 | 4 | 35 |
| 5310-00-928-2690 | 1 | 17 | MS51957-27 | 96906 | 4 | 25 |
| 5310-00-933-8119 | 2 | 33 | MS51957-43 | 96906 | 4 | 18 |
| 5310-00-934-9763 | 4 | 12 | RCR32G602JS | 81349 | 4 | 39 |

By Order of the Secretary of the Army:

BERNARD W. ROGERS
General, *United States Army*
Chief of Staff

Official:

PAUL T. SMITH
Major General, United States Army
The Adjutant General

Distribution:

Action Army:

USASA (2)
COE (1)
TSG (1)
USAARENBD (1)
DARCOM (1)
TRADOC (2)
OS Maj Cmd (4)
TECOM (2)
USACC (4)
MDW (1)
Armies (2)
Corps (2)
HISA (Ft Monmouth) (33)
Svc Colleges (1)
USASIGS (5)
USAADS (2)
USAFAS (2)
USAARMS (2)
USAIS (2)
USAES (2)
USAICS (3)
MAAG (1)
USARMIS (1)

USAERDAA (1)
USAERDAW (1)
Instls (2) except
Ft Gordon (10)
Ft Huachuca (10)
Ft Carson (5)
Ft Richardson (ECOM Ofc) (2)
LBAD (14)
SAAD (30)
TOAD (14)
SHAD (3)
Ft Gillem (10)
Sig FLDMS (1)
Units org under fol TOE:
(1 copy each unit)
11-16
11-97
11-98
11-117
11-500 (AA-AC)
29-134
29-136

NG State AG (3); Units-Same as Active Army except allowance is one copy per unit.

USAR: None

For explanation of abbreviations used, see AR 310-50.

RECOMMENDED CHANGES TO EQUIPMENT TECHNICAL MANUALS



SOMETHING WRONG WITH THIS MANUAL?

THEN... JOT DOWN THE DOPE ABOUT IT ON THIS FORM, TEAR IT OUT, FOLD IT AND DROP IT IN THE MAIL!

FROM: (YOUR UNIT'S COMPLETE ADDRESS)

Commander
Stateside Army Depot
ATTN: AMSTA-US
Stateside, N.J. 07703

DATE 10 July 1975

PUBLICATION NUMBER

TM 11-5840-340-12

DATE

23 Jan 74

TITLE

Radar Set AN/SPS-76

BE EXACT... PIN-POINT WHERE IT IS

IN THIS SPACE TELL WHAT IS WRONG AND WHAT SHOULD BE DONE ABOUT IT:

| PAGE NO. | PARA-GRAPH | FIGURE NO. | TABLE NO. |
|----------|------------|------------|-----------|
| 2-25 | 2-28 | | |
| 3-10 | 3-3 | | 3-1 |
| 5-6 | 5-8 | | |
| | | FO3 | |

Recommend that the installation antenna alignment procedure be changed through to specify a 2° IFF antenna lag rather than 1°.

REASON: Experience has shown that with only a 1° lag, the antenna servo system is too sensitive to wind gusting in excess of 25 knots, and has a tendency to rapidly accelerate and decelerate as it hunts, causing strain to the drive train. Hunting is minimized by adjusting the lag to 2° without degradation of operation.

Item 5, Function column. Change "2 db" to "3db."

REASON: The adjustment procedure for the TRANS POWER FAULT indicator calls for a 3 db (500 watts) adjustment to light the TRANS POWER FAULT indicator.

Add new step f.1 to read, "Replace cover plate removed in step e.1, above."

REASON: To replace the cover plate.

Zone C 3. On J1-2, change "+24 VDC to "+5 VDC."

REASON: This is the output line of the 5 VDC power supply. + 24 VDC is the input voltage.

TEAR ALONG DOTTED LINE

TYPED NAME, GRADE OR TITLE, AND TELEPHONE NUMBER

SSG I. M. DeSpirito 999-1776

SIGN HERE:

SSG I. M. DeSpirito

DA FORM 2028-2 (TEST) 1 AUG 74

P.S.--IF YOUR OUTFIT WANTS TO KNOW ABOUT YOUR MANUAL "FIND" MAKE A CARBON COPY OF THIS AND GIVE IT TO YOUR HEADQUARTERS.

HISA 1686-75

FILL IN YOUR
UNIT'S ADDRESS

FOLD BACK

DEPARTMENT OF THE ARMY

OFFICIAL BUSINESS

PENALTY FOR PRIVATE USE, \$300

POSTAGE AND FEES PAID
DEPARTMENT OF THE ARMY
DOD-314



Commander
US Army Electronics Command
ATTN: DRSEL-MA-Q
Fort Monmouth, New Jersey 07703

TEAR ALONG DOTTED LINE

FOLD BACK

FILL IN YOUR
UNIT'S ADDRESS

FOLD BACK

DEPARTMENT OF THE ARMY

OFFICIAL BUSINESS

PENALTY FOR PRIVATE USE, \$300

POSTAGE AND FEES PAID
DEPARTMENT OF THE ARMY
DOD-314



Commander
US Army Electronics Command
ATTN: DRSEL-MA-Q
Fort Monmouth, New Jersey 07703

TEAR ALONG DOTTED LINE

FOLD BACK

RECOMMENDED CHANGES TO EQUIPMENT TECHNICAL MANUALS



SOMETHING WRONG WITH THIS MANUAL?

THEN... JOT DOWN THE DOPE ABOUT IT ON THIS FORM, TEAR IT OUT, FOLD IT AND DROP IT IN THE MAIL!

FROM: (YOUR UNIT'S COMPLETE ADDRESS)

DATE

PUBLICATION NUMBER DATE TITLE

| BE EXACT. . . PIN-POINT WHERE IT IS | | | | IN THIS SPACE TELL WHAT IS WRONG AND WHAT SHOULD BE DONE ABOUT IT: |
|-------------------------------------|------------|------------|-----------|--|
| PAGE NO. | PARA-GRAPH | FIGURE NO. | TABLE NO. | |
| | | | | |

TEAR ALONG DOTTED LINE

TYPED NAME, GRADE OR TITLE, AND TELEPHONE NUMBER

SIGN HERE:

FILL IN YOUR
UNIT'S ADDRESS

FOLD BACK

DEPARTMENT OF THE ARMY

OFFICIAL BUSINESS

PENALTY FOR PRIVATE USE, \$300

POSTAGE AND FEES PAID
DEPARTMENT OF THE ARMY
DOD-314



Commander
US Army Electronics Command
ATTN: DRSEL-MA-Q
Fort Monmouth, New Jersey 07703

FOLD BACK

TEAR ALONG DOTTED LINE

DEPARTMENT OF THE ARMY
US ARMY AG PUBLICATIONS CENTER
1635 WOODSON ROAD
ST. LOUIS, MISSOURI 63114

OFFICIAL BUSINESS
PENALTY FOR PRIVATE USE \$300

POSTAGE AND FEES PAID
DEPARTMENT OF THE ARMY
DOD 314

